

1 1/2" DRIVE SOCKETS & ATTACHMENTS

6 Point Standard Length - Impact Black Industrial Finish

Hex Size	6 Point Part No.	Overall Length in. a	Drive End in. b	Hex End in. c	Taper Length in. d	Bolt Clearance in. e
1 5/16"	8-642	3.07	3.39	2.36	1.93	1.22
1 3/8"	8-644	3.07	3.39	2.44	1.75	1.3
1 7/16"	8-646	3.07	3.39	2.52	1.65	1.34
1 1/2"	8-648	3.07	3.39	2.6	1.52	1.42
1 9/16"	8-650	3.07	3.39	2.68	1.38	1.48
1 5/8"	8-652	3.15	3.39	2.76	1.24	1.54
1 11/16"	8-654	3.15	3.39	2.8	1.17	1.61
1 3/4"	8-656	3.31	3.39	2.95	0.9	1.67
1 13/16"	8-658	3.31	3.39	2.99	0.83	1.69
1 7/8"	8-660	3.31	3.39	3.07	0.69	1.75
1 15/16"	8-662	3.43	3.39	3.15	0.55	1.77
2"	8-664	3.43	3.39	3.23	0.42	1.81
2 1/16"	8-666	3.43	3.39	3.27	0.35	1.85
2 1/8"	8-668	3.54	3.39	3.39	—	2.13
2 3/16"	8-670	3.54	3.39	3.39	—	2.13
2 1/4"	8-672	3.62	3.39	3.39	—	2.13
2 5/16"	8-674	3.62	3.39	3.62	—	2.13
2 3/8"	8-676	3.62	3.39	3.66	—	2.17
2 7/16"	8-678	3.74	3.39	3.78	—	2.24
2 1/2"	8-680	3.74	3.39	3.82	—	2.3
2 9/16"	8-682	3.74	3.39	3.82	—	2.36
2 5/8"	8-684	3.94	3.39	4.06	—	2.42
2 11/16"	8-686	3.94	3.39	4.09	—	2.48
2 3/4"	8-688	3.94	3.39	4.13	—	2.56
2 13/16"	8-690	4.06	3.39	4.25	—	2.6
2 7/8"	8-692	4.06	3.39	4.25	—	2.68
2 15/16"	8-694	4.06	3.39	4.33	—	2.76
3"	8-696	4.06	3.39	4.33	—	2.8
3 1/16"	8-698	4.33	3.39	4.53	—	2.85
3 1/8"	8-6100	4.33	3.39	4.57	—	2.91
3 3/16"	8-6102	4.33	3.39	4.92	—	2.99
3 1/4"	8-6104	4.33	3.39	4.92	—	3.05
3 5/16"	8-6106	4.65	3.39	4.92	—	3.11
3 3/8"	8-6108	4.65	3.39	4.92	—	3.17
3 7/16"	8-6110	4.65	3.39	5.04	—	3.23
3 1/2"	8-6112	4.65	3.39	5.12	—	3.31
3 9/16"	8-6114	4.65	3.39	5.12	—	3.37
3 5/8"	8-6116	4.65	3.39	5.12	—	3.43
3 11/16"	8-6118	4.65	3.39	5.12	—	3.48
3 3/4"	8-6120	4.65	3.74	5.39	—	3.54
3 13/16"	8-6122	4.92	3.74	5.51	—	3.62
3 7/8"	8-6124	4.92	3.74	5.51	—	3.68
3 15/16"	8-6126	4.92	3.74	5.51	—	3.74
4"	8-6128	4.92	3.74	5.51	—	3.74
4 1/16"	8-6130	4.92	3.74	5.75	—	3.86
4 1/8"	8-6132	4.92	3.74	5.91	—	3.94
4 3/16"	8-6134	4.92	3.74	5.91	—	3.98
4 1/4"	8-6136	4.92	3.74	5.91	—	4.06
4 5/16"	8-6138	4.92	3.74	6.14	—	4.13
4 3/8"	8-6140	4.92	3.74	6.3	—	4.13
4 7/16"	8-6142	4.92	3.74	6.3	—	4.17
4 1/2"	8-6144	5.31	3.74	6.3	—	4.33
4 5/8"	8-6148	5.31	3.74	6.5	—	4.41
4 3/4"	8-6152	5.31	3.74	6.61	—	4.53
4 15/16"	8-6158	6.5	3.25	1.7	1.62	3.5

Style I

Style II

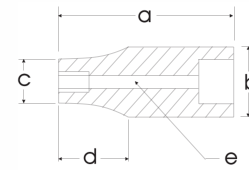

STYLE I

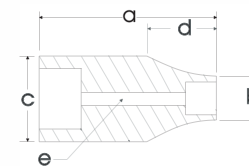

STYLE II

Federal Spec. U.S. GGG-W-660A ANSI Spec. B107.2